



STATIC LOAD



100
kN

DYNAMIC LOAD



50
kN

TORQUE at 25MPa



2800
Nm

WEIGHT



63
kg

OILFLOW



30
l/min

COMPATIBILITY



FHL02



DOUBLE BEARING

Grapple open
G1/2" Max 250 bar

Rotate left/right
G1/2" Max 250 bar

Grapple close
G1/2" Max 300 bar

Rotator designed for intensive professional use and extended long lifetime

Robust and shock resistant steel flange for fitting the grapple in standard pattern with 6xM16 bolts

Grapple close
G1/2"

Grapple open
G1/2"

Optional open/close channels

Rotator frame L80 ø35 suitable for Formiko FHL02 links

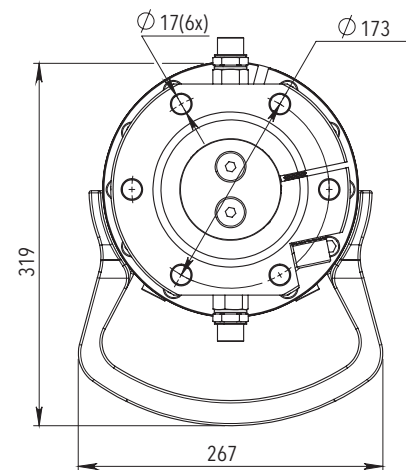
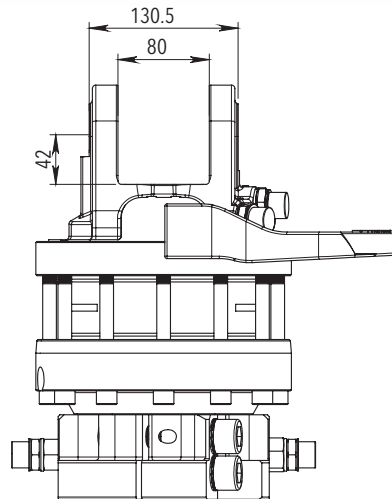
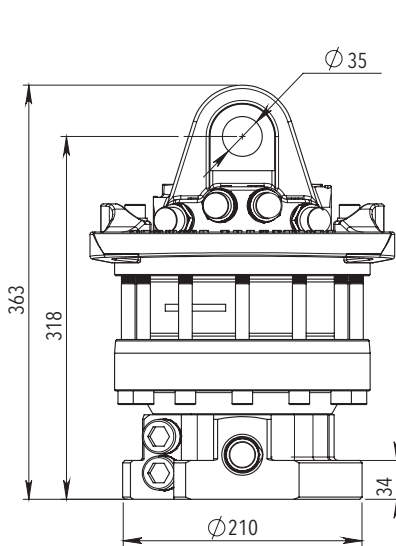

For additional information relating to price levels and technical data, please contact sales@formiko.lv

Formiko Hydraulics Ltd
Dzirciema Str. 119 k-1
Riga LV1055
LATVIA

+371 294 49 552
+371 264 59 383
sales@formiko.lv
www.formiko.lv

Formiko Hydraulics FHR 10 rotators are designed for heavy forestry and general cargo handling to meet high demands for reliability.



FORESTRY



AGRICULTURE



CONSTRUCTION



GENERAL CARGO



RECYCLING

