



STATIC LOAD



**160**  
kN

DYNAMIC LOAD



**80**  
kN

TORQUE at 25MPa



**3400**  
Nm

WEIGHT



**65**  
kg

OILFLOW



**40**  
l/min



DOUBLE BEARING

Grapple open  
G1/2" Max 250 bar

Rotate left/right  
G1/2" Max 250 bar

Grapple close  
G1/2" Max 300 bar

Rotator with increased torque for heavy duty applications

Rotator with two bearings to withstand compression and stretching forces

Robust and shock resistant steel flange for fitting the grapple in standard pattern with 6xM16 bolts

Grapple close  
G1/2"

Grapple open  
G1/2"

Optional open/close channels

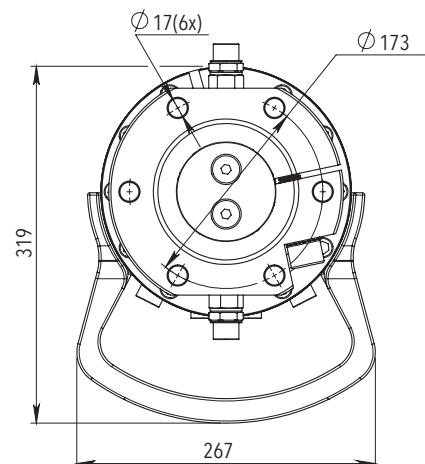
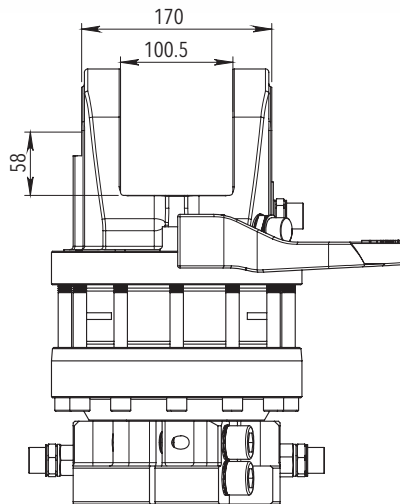
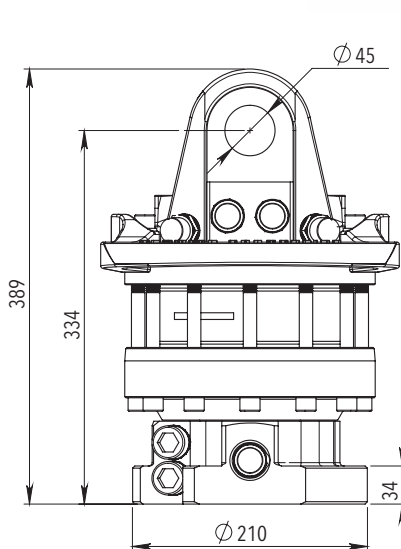

For additional information relating to price levels and technical data, please contact [sales@formiko.lv](mailto:sales@formiko.lv)

Formiko Hydraulics Ltd  
Dzirciema Str. 119 k-1  
Rīga LV1055  
LATVIA

+371 294 49 552  
+371 264 59 383  
[sales@formiko.lv](mailto:sales@formiko.lv)  
[www.formiko.lv](http://www.formiko.lv)

Formiko Hydraulics FHR 16 rotators are developed for heavy duty machinery to meet the highest demands for quality and reliability.



FORESTRY



AGRICULTURE



CONSTRUCTION



GENERAL CARGO



RECYCLING

