



STATIC LOAD



**60**  
kN

DYNAMIC LOAD



**30**  
kN

TORQUE at 25MPa



**1850**  
Nm

WEIGHT



**57**  
kg

OILFLOW



**25**  
l/min



**DOUBLE BEARING**

Grapple close

G1/2" Max 300 bar

Extra tool 1

G1/2" Max 300 bar

Rotate left/right

G1/2" Max 300 bar

Rotator designed for intensive professional use and extended long lifetime

Extra tool 1

1/2"

Upper flange 10xM12 on  $\varnothing 144$   
+ 2 locating pins

Grapple open

G1/2" Max 250 bar

Extra tool 2

G1/2" Max 300 bar

Rotator with two bearings to withstand compression and stretching forces

Extra tool 2

1/2"

Shock resistant steel flange for reliable fitting the grapple

Grapple open/close

G1/2"

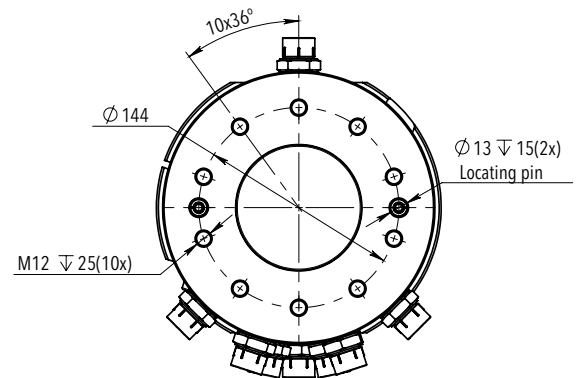
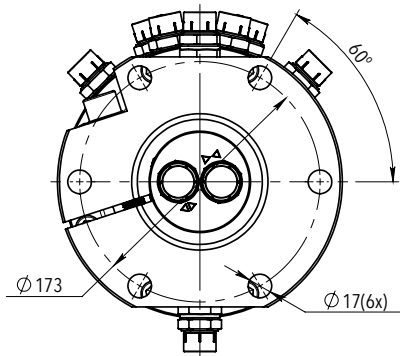
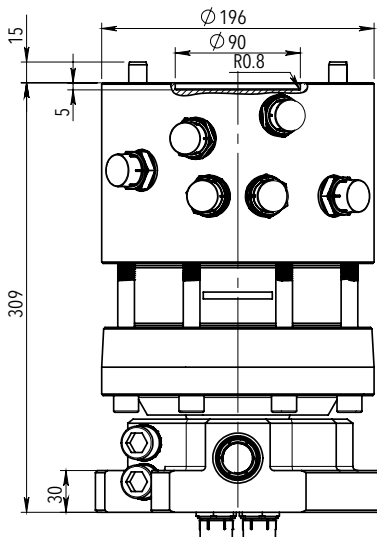

For additional information relating to price levels and technical data, please contact [sales@formiko.lv](mailto:sales@formiko.lv)

Formiko Hydraulics FHR 6 rotators are ideal for professional forestry and general cargo handling.

FORESTRY



AGRICULTURE



CONSTRUCTION



GENERAL CARGO



RECYCLING



Formiko Hydraulics Ltd  
Dzirciema Str. 119 k-1  
Riga LV1055  
LATVIA

+371 294 49 552  
+371 264 59 383  
[sales@formiko.lv](mailto:sales@formiko.lv)  
[www.formiko.lv](http://www.formiko.lv)